

1 Site
1" = 20'-0"



Simp-Fielder Garage
PN: 486835

2430 Via Kachess Rd.
Easton, WA 98925

Project Number:	2019-67
Date:	2/01/2020
Designed:	DN
Drawn:	JZ

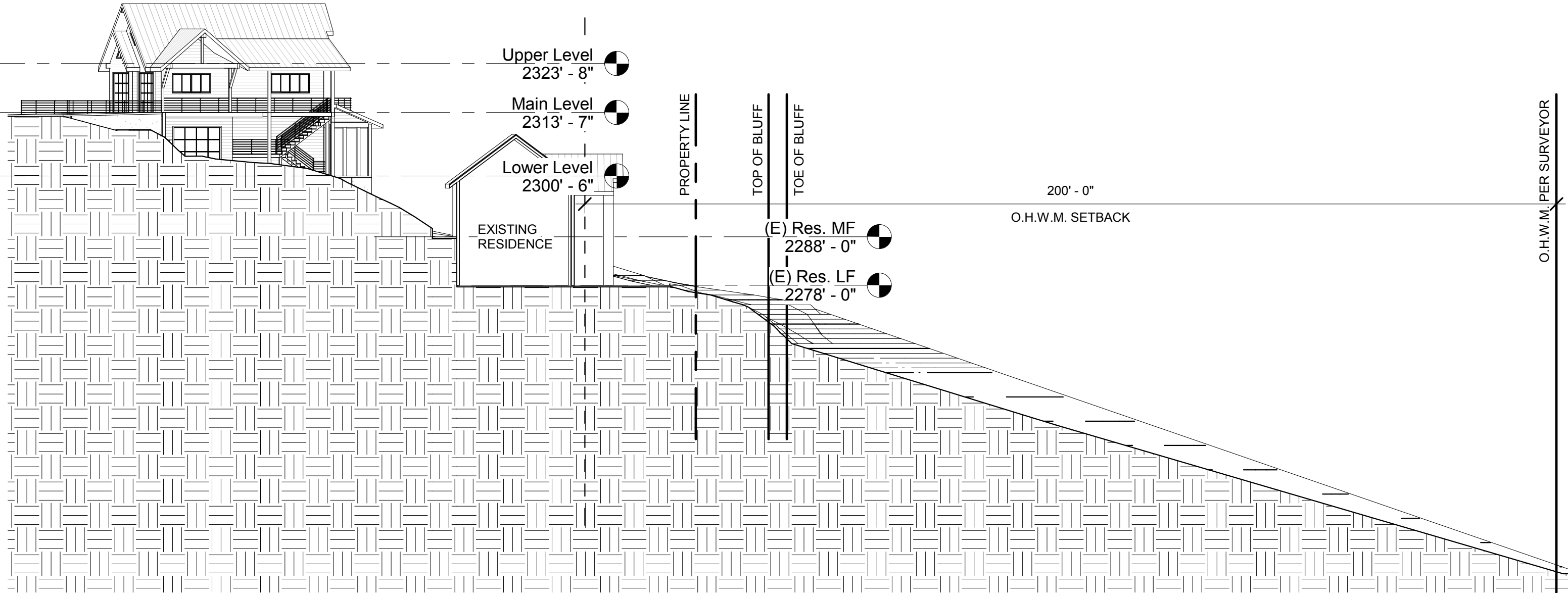

1 Site Section
1" = 20'-0"



Simp-Fielder Garage
PN: 486835

2430 Via Kachess Rd.
Easton, WA 98925

Project Number:	2019-67
Date:	2/01/2020
Designed:	DN
Drawn:	JZ